

REFERENCE : R.O.W. MAP NO. 101-14
SHEET 3 OF 6

**END FULL DEPTH
CONSTRUCTION
STA. 29+00**

MATCH MARK STA. 24+00 - SEE DRAWING NO. PLN-67

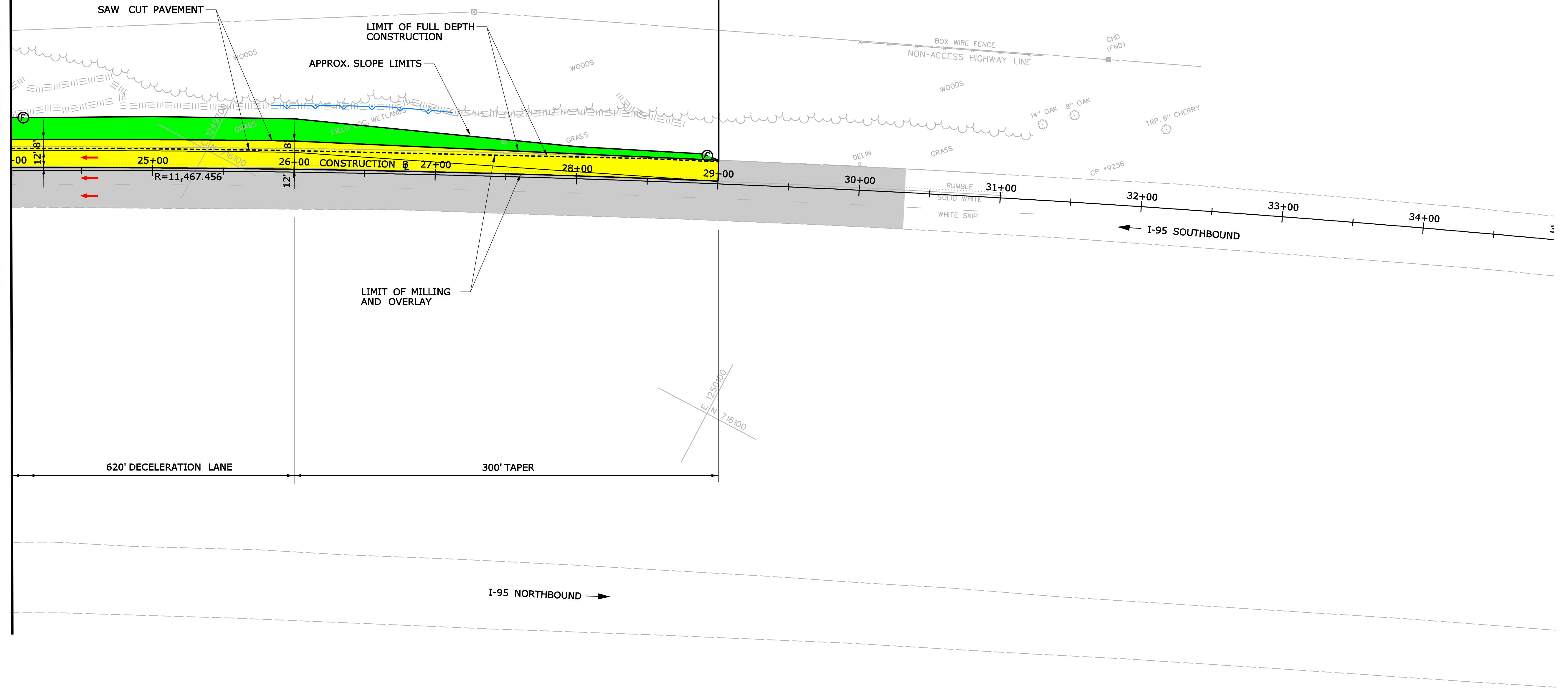

PRELIMINARY DESIGN REVIEW

Plotted: 3/28/2008	DESIGNER/DRAFTER: S. GWARA
Border Version: 5/31/07	CHECKED BY: F. MOSELEY
THE INFORMATION, INCLUDING ESTIMATED QUANTITIES OF WORK, SHOWN ON THESE SHEETS IS BASED ON LIMITED INVESTIGATIONS BY THE STATE AND IS IN NO WAY WARRANTED TO INDICATE THE CONDITIONS OF ACTUAL QUANTITIES OF WORK WHICH WILL BE REQUIRED.	ENGINEER: FAY, SPOFFORD & THORNDIKE
REV. DATE REVISION DESCRIPTION SHEET NO.	APPROVED BY: - DATE: -
Filename: \$FILESLS\$	Date Plotted: 3/28/2008

SCALE IN FEET
0 40 80
SCALE 1"=40'

**STATE OF CONNECTICUT
DEPARTMENT OF TRANSPORTATION**

PROJECT TITLE:
**SAFETY IMPROVEMENTS AND
BRIDGE MAINTENANCE ON I-95**

TOWN:
NORTH STONINGTON

DRAWING TITLE:
**CONSTRUCTION PLAN
EXIT 92 SB OFF RAMP**

PROJECT NO.
58-307

DRAWING NO.
PLN-68

SHEET NO.